

CLINCHING FASTENERS CO., LTD.

BLIND STANDOFFS 盲孔壓鉚螺柱

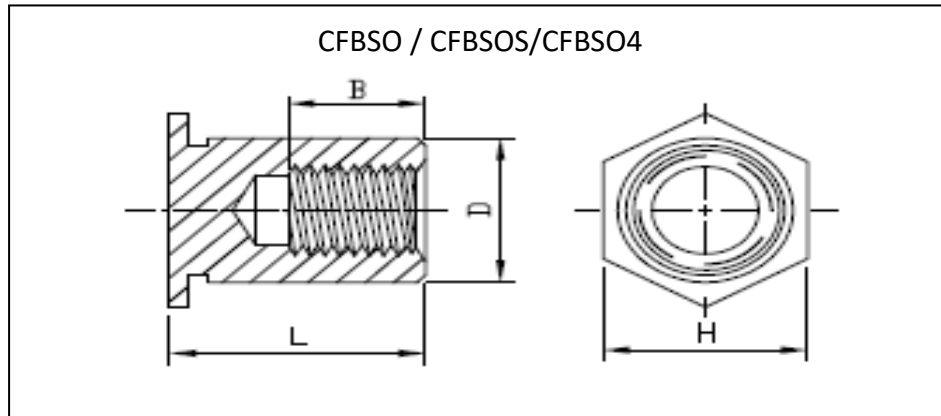

Material 材質： Steel 鋼 (CFBSO) / Stainless Steel 不鏽鋼 (CFBSOS) / Hardened Stainless Steel (400 series) 鈍化處理不鏽鋼(CFBSO4)

Finish 表面： Cr3+ Zinc 三價鋅(CFBSO) / Plain 原色 (CFBSOS) / Passivation Plain 鈍化原色(CFBSO4)
CFBSO / CFBSOS / CFBSO4 Dimensions: ISO metric /mm

Apply Part Code 適用產品編號	Thread Size 螺紋尺寸	H Norm.	D -0.13	Min. Sheet Thickness 最小板厚	Hole Size in Sheet +0.08 板孔徑	Min. Dist. Hole C/L to Edge
CFBSO / CFBSOS	M2.5x0.45	4.8	4.19	1.00	4.20	6.0
CFBSO / CFBSOS / CFBSO4	M3x0.5	4.8	4.20	1.02	4.22	6.0
CFBSO / CFBSOS / CFBSO4	3.5M3x0.5	6.4	5.39	1.02	5.41	6.8
CFBSO / CFBSOS / CFBSO4	M4x0.7	7.9	7.12	1.27	7.14	8.0
CFBSO / CFBSOS / CFBSO4	M5x0.8	7.9	7.12	1.27	7.14	8.0

Thread Size 螺紋尺寸	L 長度(Tolerance : +0.05/-0.13)											
M2.5x0.45	6	8	10	12	14	16	N/A	N/A	N/A	N/A	N/A	N/A
M3x0.5 / 3.5M3	6	8	10	12	14	16	18	20	22	24	25	26
M4x0.7	6	8	10	12	14	16	18	20	22	24	25	26
M5x0.8	6	8	10	12	14	16	18	20	22	24	25	26
Counter B Min. 螺牙深度	3.2	4.0	5.0	6.5	9.5							

Dimensions: inch

Apply Part Code 適用產品編號	Thread Size & Code 螺紋尺寸及代碼	H Norm.	D +.000 -.005	Min. Sheet Thickness 最小板厚	Hole Size in Sheet +.003 -.000	Min. Dist. Hole C/L to Edge
CFBSO / CFBSOS / CFBSO4	440(#4-40)	.187	.165	.040	.166	.23
CFBSO / CFBSOS / CFBSO4	6440(#4-40)	.250	.212	.040	.213	.27
CFBSO / CFBSOS / CFBSO4	632(#6-32)	.250	.212	.040	.213	.27
CFBSO / CFBSOS / CFBSO4	8632(#6-32)	.312	.280	.050	.281	.31
CFBSO / CFBSOS / CFBSO4	832(#8-32)	.312	.280	.050	.281	.31
CFBSO / CFBSOS / CFBSO4	032(#10-32)	.312	.280	.050	.281	.31

Thread Size 螺紋尺寸	L 長度 (Tolerance : +.002/-.005)												
	.312	.375	.437	.500	.562	.625	.687	.750	.812	.875	.937	1.00	1.062
.112-40(#4-40)	10	12	14	16	18	20	22	24	26	28	30	32	34
.138-32(#6-32)	10	12	14	16	18	20	22	24	26	28	30	32	34
.164-32(#8-32)	10	12	14	16	18	20	22	24	26	28	30	32	34
.190-32(#10-32)	10	12	14	16	18	20	22	24	26	28	30	32	34
Counter B Min. 螺牙深度	.156		.187	.250			.375						

PERFORMANCE DATE 性能數據表

TYPE 產品種類	Thread Size 螺紋尺寸	Sheet Material 板材料	Installation (KN) 安裝力	Push-out (N) 推力	Torque-out (N*m) 扭力
CFBSO CFBSOS	M3	1.5mm 5052-H34 Aluminum 鋁板	4.9	710	1.24
	3.5M3		7.6	1330	2.82
	M4		10.7	1780	5.08
	M5		9.8	1000	2.15
	M3	1.5mm SPCC 冷軋鋼板	14.7	1860	3.95
	3.5M3		17.8	2490	8.47
	M4		24.5	1493	2.36
	M5		42.3	2877	3.06
CFBSO4	M3	1.3mm 300 Serial Stainless Steel 不繡鋼板	46.7	4003	8.89
	3.5M3				
	M4				
	M5				

TYPE 產品種類	Thread Size 螺紋尺寸	Sheet Material 板材料	Installation (lbs.) 安裝力	Push-out (lbs.) 推力	Torque-out (in*lbs) 扭力	
CFBSO CFBSOS	440(#4-40)	.060 inch 5052-H34 Aluminum 鋁板	1100	160	11	
	6440(#4-40)		1700	300	25	
	632(#6-32)		.060 inch SPCC 冷軋鋼板	2400	400	45
	8632(#6-32)			2200	225	19
	832(#8-32)			3300	420	35
	032(#10-32)			4000	560	75
	440(#4-40)	.050 inch 300 Serial Stainless Steel 不繡鋼板		5500	336	17
	6440(#4-40)			9500	647	30
	632(#6-32)		10500	900	71	
	8632(#6-32)					
	832(#8-32)					
	032(#10-32)					